

James Hagerthy

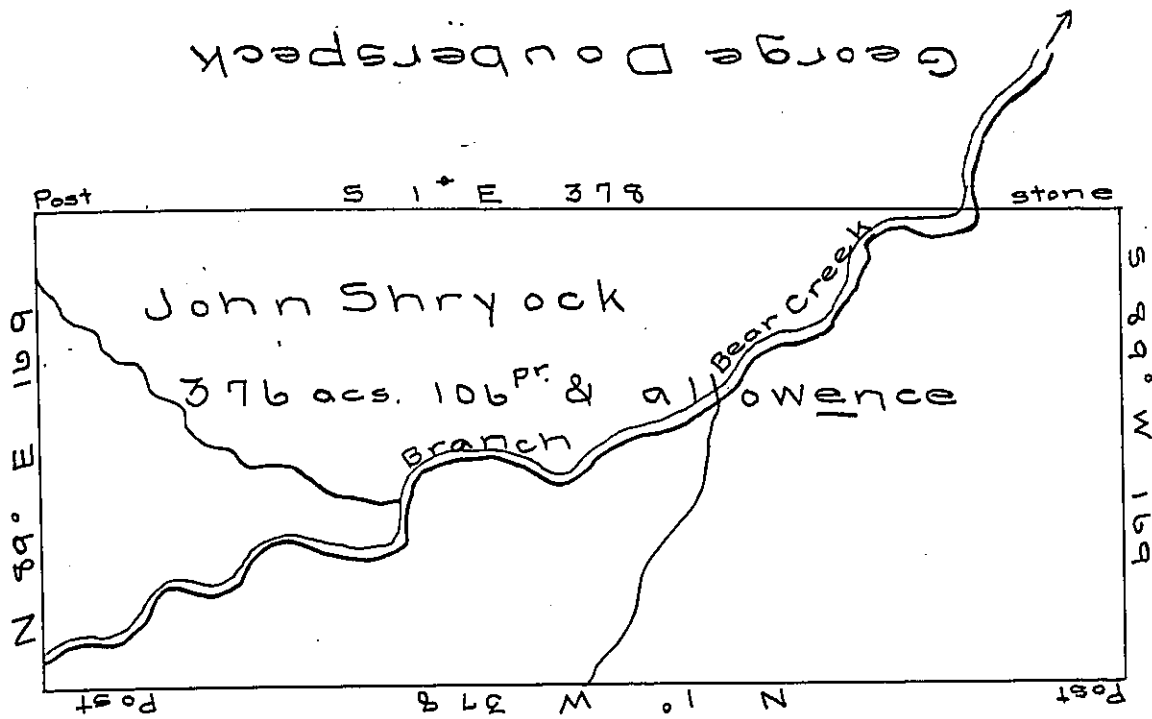

John Hindman

Heirs of John Mechling dec'd

Draft of a tract of land situated in Parker Tp. Butler County on the watters of Bear creek containing 376 acres & 106 pr. & allowance. Surveyed for John Shryock on the 8th May A.D. 1828 by virtue of his settlement & residence.

Hugh Conway D.S.

I, James Dunlap Deputy Surveyor of the District of Butler County, do certify the above to be a true copy of a draft, found in the Entry Book of Hugh Conway, former Deputy Surveyor of Butler County.

James Dunlap  
Depty Suvr  
Butler Co.

Jacob Sallade Esq.  
Surveyor Gn'l Penna.

*IN TESTIMONY* that the above is a copy of the original remaining on file in the Department of Internal Affairs of Pennsylvania, made conformably to an Act of Assembly approved the 16th day of February 1833, I have hereunto set my hand and caused the Seal of said Department to be affixed at Harrisburg, this sixteenth day of April 1907.

*James N. Brown*  
Secretary of Internal Affairs.